

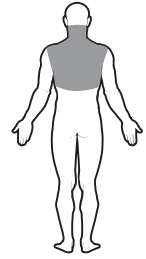

FOR USE WITH
**GAME READY
GRPRO® 2.1 SYSTEM**

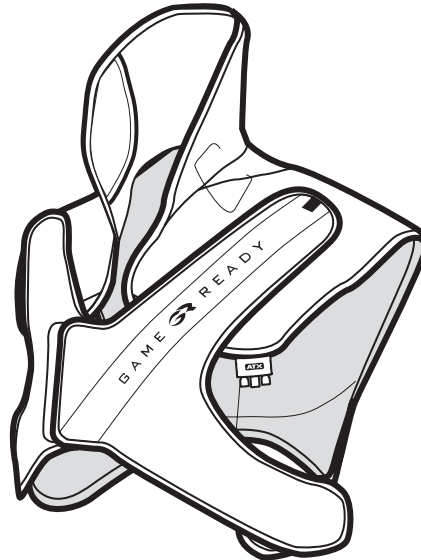

C-T SPINE USE GUIDE

ENGLISH

SIZING SPECIFICATIONS

- Size: One Size

ASSEMBLY

The Heat Exchanger (PN 520502-03) fits inside the Sleeve (PN 510502) and comes as part of a pre-assembled Wrap (PN 590502-03). If the Heat Exchanger is removed to launder the Sleeve or for any other reason, please use the following instructions to re-insert the Heat Exchanger into the Sleeve.

- 1 Lay the Sleeve with the zipper side down on a flat surface and remove the chest straps (C), then turn the Sleeve over so the zipper is facing up.
- 2 Lay the Heat Exchanger out flat, separate from the outer sleeve. Insert the Heat Exchanger into the Sleeve by feeding the connector through the opening (F) on the left shoulder. The blue side of the Heat Exchanger should touch the blue side of the Sleeve.
- 3 Be sure the Heat Exchanger is flat inside the sleeve on the back and shoulder areas. In order for the collar to lay correctly, rotate the shoulder wings back (A), then smooth the heat exchanger inside the collar. Zip the sleeve closed, and flip the Wrap over with the shoulder wings facing forward. The Wrap should resemble a vest with a high collar. Attach the chest straps (C) to complete assembly, orienting the logo on the chest straps as shown.

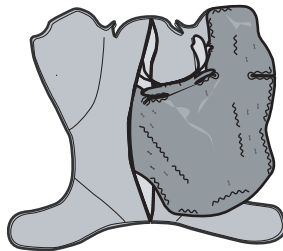
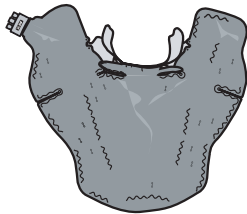

WARNING

It is mandatory to fully read and understand your System's User Manual before using the device. Failure to follow operating instructions could result in serious injury.



IMPORTANT

Read complete indications, contraindications, cautions, and warning before using this product. Keep this document for future reference.

BEFORE INITIAL USE

Prime the Wrap using the following steps:

- With the **GRPro 2.1 Control Unit** off, attach the Connector Hose to the Control Unit and the Wrap
- Lay the Wrap open and flat next to the Control Unit (not on the body)
- Turn the System on and run for 2 minutes with No Pressure

REMOVAL OF HEAT EXCHANGER

1. Disconnect the Connector Hose from the Wrap
2. Unzip the zipper
3. Gently pull out the Heat Exchanger

STORAGE OF YOUR WRAP

Hang your Wrap on a wide hanger or lay flat. Do not fold or stack it, as this could kink the fluid chamber and the Wrap will not work properly.

C-T SPINE WRAP APPLICATION

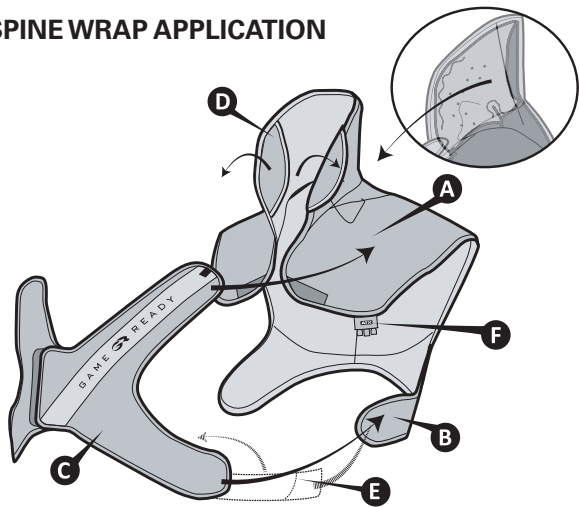

1 Slide one arm through the Wrap.



2 Slide the other arm through the other side of Wrap.



3 Take hold of the shoulder wings (A) and pull the Wrap down gently to ensure good contact with the back of the neck.



4 Fasten the hook and loop closure at the center of the chest.



5 Adjust the two side straps (B & C) equally on both sides of the body.

Elastic extension bands (E) on each side of the chest straps allow the Wrap to accommodate various body sizes. Unfasten the side straps; detach the elastic strap on the inside and reattach the loop towards the back of the Wrap. Repeat for the other side.



6 Adjust the two shoulder straps (A & C) by completely unhooking and reapplying them over the chest and shoulders – Take care to keep Connector (F) unobstructed.

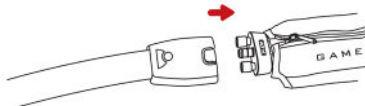

7 Attach the Wrap to the Control Unit with the Connector Hose. There should be an audible “click!”. To disconnect, simply press the blue or gray button and remove the connector from the Wrap.

GRPRO 2.1 CONTRAINDICATIONS

| | THERAPY MODE | |
|--|--------------|-------------|
| | Cryotherapy | Compression |
|  X = Absolute Contraindication – Therapy in these situations should not be used in patients: R = Relative Contraindication – Therapy for these conditions should be used only under the supervision of a licensed healthcare practitioner in patients: | | |
| Who are in the acute stages of inflammatory phlebitis in the affected region. | | X |
| Who have any current clinical signs suggestive of deep vein thrombosis in the affected region. | | X |
| Who have significant arteriosclerosis or other vascular ischemic disease in the affected region. | | X |
| Who have any significant risk factors or current clinical signs of embolism (e.g. pulmonary embolus, cerebral infarction, atrial fibrillation, endocarditis, myocardial infarction, or atheromatous embolic plaque). | | X |
| Who have a condition in which increased venous or lymphatic return is not desired in the affected extremity (e.g., carcinoma). | | X |
| Who have decompensated hypertonia in the affected region. | | X |
| Who have an open wound in the affected region (the wound must be dressed prior to use of Game Ready). | | R |
| Who have an acute, unstable (untreated) fracture in the affected region. | | R |
| Who are children under 18 years old or patients who have cognitive disabilities or communication barriers, whether temporary (due to medication) or permanent. | R | R |
| Who have a cardiac insufficiency or congestive heart failure (with associated edema in the extremities or lungs). | | R |
| Who have a localized unstable skin condition (e.g., dermatitis, vein ligation, gangrene, or recent skin graft). | R | R |
| Who have erysipelas or other active infection in the affected region. | | R |
| Who have significant vascular impairment in the affected region (e.g., from prior frostbite, diabetes, arteriosclerosis or ischemia). | X | |
| Who have known hematological dyscrasias which affect thrombosis (e.g., paroxysmal cold hemoglobinuria, cryoglobulinemia, sickle-cell disease, serum cold agglutinins). | X | |
| Who have Raynaud’s disease or cold hypersensitivity (cold urticaria). | R | |
| Who have hypertension or extreme low blood pressure. | R | |
| Who have diabetes. | R | |
| Who have compromised local circulation or neurologic impairment (including paralysis or localized compromise due to multiple surgical procedures) in the affected region. | R | |
| Who have rheumatoid arthritis in the affected region. | R | |

GENERAL



IMPORTANT

**THIS WRAP IS INTENDED FOR USE WITH LOW PRESSURE SETTING.
PRESSURE CAN BE TURNED OFF AS DESIRED.**

READ THIS COMPLETE USE GUIDE AND GAME READY GRPRO 2.1 SYSTEM USER MANUAL INCLUDING INDICATIONS, CONTRAINDICATIONS, CAUTIONS AND WARNINGS BEFORE USING THIS PRODUCT!

WARNINGS

- **THE C-T SPINE WRAP IS NOT TO BE USED CONTINUOUSLY FOR GREATER THAN 15 MINUTES PER TREATMENT SESSION.**
- Follow the recommendations of your health care practitioner regarding the frequency and duration of use.
- Improper placement or prolonged use of the Game Ready System could result in tissue damage. During the course of therapy, patients should monitor the skin surrounding the treated region or the digits of the extremities of the treated limb for any burning, itching, increased swelling, or pain. If any of these signs present, or any changes in skin appearance occur (such as blisters, increased redness, discoloration, or other noticeable skin changes), patients are advised to discontinue use and consult a physician.
- Game Ready Wraps are not sterile; do not place directly against open wounds, sores, rashes, infections, or stitches. The Wrap may be applied over clothing or dressing. A layer of clothing between Wrap and skin is recommended for all patients.
- Game Ready Wraps are available in multiple configurations but are not intended for all possible physiologic uses. For example, the Ankle Wrap is not designed for use on the toes and the Back Wrap is not designed for use in the abdominal region.
- To avoid potential damage to the Control Unit, do not use other manufacturers' Wraps with the Control Unit.
- Use extra caution during the immediate postoperative period, especially when sedated or on any medication that could alter normal pain sensation. Check the skin of the treated region frequently and use mid-to-higher (warmer) temperature range settings or leave more time between treatments, if necessary.

NOTES

Apply Wrap with a uniformly close fit, ensuring there are no kinks which may impede water flow. Ensure connector hose is placed to prevent the Wrap from folding or kinking at the hose inlet location of the Wrap.

CARE AND CLEANING

For daily care and to minimize formation of mildew, remove Heat Exchanger from Sleeve and wipe with dry towel to remove any condensation that may form. Turn Sleeve inside out and hang both the Sleeve and Heat Exchanger to release excess moisture. For multi-patient use, if needed, use Sterifab® according to manufacturer's instructions to minimize microbe transfer.

For extended care, carefully remove the Heat Exchanger and all four plastic support pieces (2 neck, 2 back) from the sleeve and turn the Sleeve inside out. Hand or machine wash the sleeve in cold water and mild detergent, or antibacterial soap. Hang to dry. Heat Exchanger should be wiped with warm water and mild detergent-do not machine wash or place in a dryer. Hang to dry. Return plastic support pieces to Sleeve before using the Wrap.

INSULATION

There is an insulation flap (D) at the top of the neck collar. If the collar fits below your ears, flip the insulation flap outward extending the cooling area. If the collar covers your ears, keep the insulation flap tucked inside the Wrap.

After fitting the Wrap properly, you should not have to readjust the chest straps for subsequent treatments. Unhook the closure at the center of the chest and remove the Wrap. To reapply, slide the Wrap on like a vest and fasten the hook closure at the center of the chest.

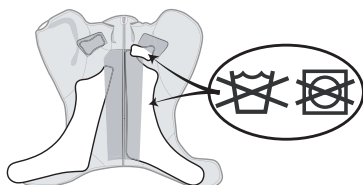

AVERAGE LIFE EXPECTANCY

The life expectancy of Sleeves and Heat Exchangers will vary widely depending on frequency of use. Please reference chart below to determine when to replace product.

Sleeve

Light Use (Personal)..... 12 months
Medium Use..... 6 months
Heavy Use (Clinic or training facility) 3 months

Heat Exchanger

Light Use (Personal)..... 24 months
Medium Use..... 18 months
Heavy Use (Clinic or training facility) 12 months

WARRANTY INFORMATION

Sleeve: In case of manufacturer defect, Sleeve may be returned within 7 days of purchase.

Heat Exchanger: 1 year from date of purchase. See warranty card included with Heat Exchanger.

CONTACT US

In the U.S. call Game Ready Customer Service at 1.888.426.3732 (+1.510.868.2100). From outside of the U.S. please refer to www.gameready.com to find your local distributor's contact information.

A list of current patent(s) covering Game Ready technology can be found at: www.gameready.com/patents.



Symbol for "assembled in" a specific country (XXXX).



Symbol for "made in" a specific country (XXXX).

Warning: To comply with California Proposition 65, the following warning has been included: This product contains chemicals known to the State of California to cause cancer, birth defects or other reproductive harm.

Wrap (PN 590502-03) includes Sleeve (PN 510502) & Heat Exchanger (PN 520502-03)

 **EC REP**
EMERGO EUROPE
Prinsessegracht 20
2514 AP The Hague
The Netherlands

 **COOLSYSTEMS® INC.**
1800 Sutter Street, Suite 500
Concord, CA 94520 USA
1.888.GAMEREADEY +1.510.868.2100
www.gameready.com

©2017 CoolSystems, Inc. All Rights Reserved
Game Ready Dual Action Wrap Use Guide

C-T Spine Wrap PN 704579 Rev C

EMERGO AUSTRALIA
201 Sussex Street
Darling Park, Tower II, Level 20
Sydney NSW 2000
Australia